

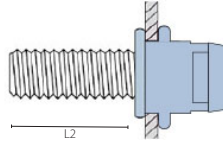

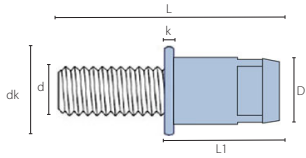

Q-BOLT

Body: **Steel Alloy**
Zinc plated
Flat head

Hülse: **Stahl Legierung**
Verzinkt
Flachkopf

Cuerpo: **Acero Aleación**
Cincado
Cabeza ancha



d	D	L1xL2	 min - max	 Ø	dk	k	L	 [Nm]	 [N]	code
	Ø	mm	mm	mm	Ø	min	mm			
M5	6.9	12.0 x 15	0.5 - 3.0	7.0	10.0	1.0	27.0	7.0	7000	02ST10F0512
		12.0 x 25	0.5 - 3.0				37.0			02ST10F0513
M6	8.9	14.5 x 15	0.5 - 3.0	9.0	13.0	1.5	29.5	10.0	10000	02ST10F0612
		14.5 x 25	0.5 - 3.0				39.5			02ST10F0613
M8	10.9	15.5 x 20	0.5 - 3.0	11.00	16.0	1.5	35.0	30.0	21000	02ST10F0812
		15.5 x 25	0.5 - 3.0				40.0			02ST10F0813