

Q-STANDARD



Body: **Steel**
Stem: **Steel**
Dome head





Hülse: **Stahl**
Dorn: **Stahl**
Flachrundkopf

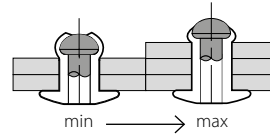
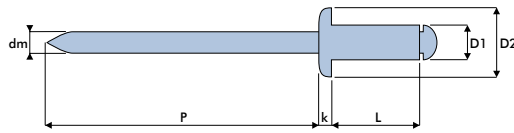

Cuerpo: **Acero**
Vástago: **Acero**
Remache alomada

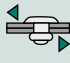

DIN EN ISO 15979

D1	L	 min - max	 mm	D2	k max.	dm ref.	p min.	 [N]	 [N]	code
mm	mm	mm	mm	mm	mm	mm	mm	[N]	[N]	
3.0	5.0	0.5 - 1.5	3.1	6.3	1.0	1.75	26	1100	950	10SS13005
	6.0	0.5 - 3.0								10SS13006
	8.0	3.0 - 5.0								10SS13008
	10.0	5.0 - 6.5								10SS13010
	12.0	6.5 - 8.0								10SS13012
	14.0	7.0 - 10.0								10SS13014
	16.0	8.0 - 12.0								10SS13016
	18.0	10.0 - 14.0								10SS13018
	20.0	12.0 - 16.0								10SS13020
3.2	5.0	0.5 - 1.5	3.3	6.3	1.0	1.92	26	1200	1100	10SS13205
	6.0	0.5 - 3.0								10SS13206
	8.0	3.0 - 5.0								10SS13208
	10.0	5.0 - 6.5								10SS13210
	12.0	6.5 - 8.0								10SS13212
	14.0	7.0 - 9.0								10SS13214
	16.0	8.0 - 12.0								10SS13216
	18.0	10.0 - 14.0								10SS13218
	20.0	12.0 - 16.0								10SS13220
4.0	6.0	1.0 - 3.0	4.1	8.0	1.3	2.35	27	2200	1700	10SS14006
	8.0	3.0 - 5.0								10SS14008
	10.0	5.0 - 6.5								10SS14010
	12.0	6.5 - 8.0								10SS14012
	14.0	7.5 - 10.0								10SS14014
	16.0	9.0 - 12.0								10SS14016
	18.0	10.0 - 14.0								10SS14018
	20.0	12.0 - 16.0								10SS14020
	22.0	15.0 - 17.0								10SS14022
	24.0	17.0 - 19.0								10SS14024
	25.0	16.0 - 21.0								10SS14025
26.0	19.0 - 21.0								10SS14026	
30.0	21.0 - 25.0								10SS14030	

Q-STANDARD



Body: **Steel**
Stem: **Steel**
Dome head



Hülse: **Stahl**
Dorn: **Stahl**
Flachrundkopf



Cuerpo: **Acero**
Vástago: **Acero**
Remache alomada

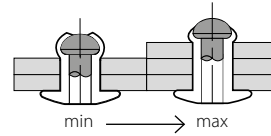
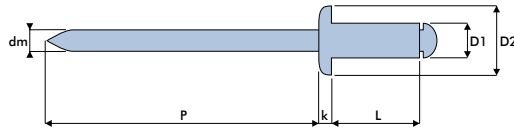

DIN EN ISO 15979

D1	L	 min - max	 mm	D2	k max.	dm ref.	p min.	 [N]	 [N]	code
mm	mm	mm	mm	mm	mm	mm	mm	[N]	[N]	
4.8	6.0	1.0 - 2.0	4.9	9.5	1.4	2.90	28	3100	2900	10SS14806
	8.0	2.5 - 4.0								10SS14808
	10.0	4.0 - 6.0								10SS14810
	12.0	6.0 - 8.0								10SS14812
	14.0	7.5 - 9.5								10SS14814
	16.0	8.0 - 11.0								10SS14816
	18.0	10.0 - 13.0								10SS14818
	20.0	11.0 - 15.0								10SS14820
	22.0	13.0 - 17.0								10SS14822
	25.0	15.0 - 19.5								10SS14825
	28.0	17.0 - 21.0								10SS14828
30.0	19.5 - 25.0								10SS14830	
5.0	8.0	2.5 - 4.0	5.1	9.5	1.4	2.90	28	4000	3100	10SS15008
	10.0	4.0 - 6.0								10SS15010
	12.0	6.0 - 8.0								10SS15012
	14.0	7.5 - 9.5								10SS15014
	16.0	8.0 - 11.0								10SS15016
	18.0	10.0 - 13.0								10SS15018
	20.0	11.0 - 15.0								10SS15020
	22.0	13.0 - 17.0								10SS15022
	25.0	15.0 - 19.5								10SS15025
	30.0	19.5 - 25.0								10SS15030



Body: **Steel**
Stem: **Steel**
Dome head





Hülse: **Stahl**
Dorn: **Stahl**
Flachrundkopf

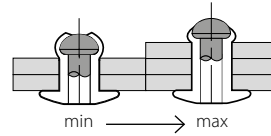
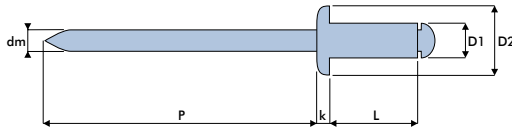

Cuerpo: **Acero**
Vástago: **Acero**
Remache alomada

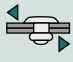

DIN EN ISO 15979

D1	L	 min - max	 mm	D2	k max.	dm ref.	p min.	 [N]	 [N]	code
mm	mm	mm	mm	mm	mm	mm	mm	[N]	[N]	
6.0	10.0	2.5 - 4.0	6.1	12.0	1.9	3.65	30	4800	4300	10SS16010
	12.0	4.0 - 6.0								10SS16012
	14.0	5.0 - 8.0								10SS16014
	15.0	7.0 - 9.0								10SS16015
	16.0	6.0 - 10.0								10SS16016
	18.0	7.0 - 11.0								10SS16018
	22.0	11.0 - 15.0								10SS16022
	26.0	14.0 - 19.0								10SS16026
30.0	19.0 - 24.0								10SS16030	
6.4	8.0	1.0 - 3.0	6.5	13.0	2.2	3.80	32	5700	4900	10SS16408
	10.0	3.0 - 4.0								10SS16410
	12.0	4.0 - 6.0								10SS16412
	15.0	5.0 - 8.0								10SS16415
	18.0	7.0 - 10.0								10SS16418
	22.0	10.0 - 14.0								10SS16422
	26.0	14.0 - 19.0								10SS16426
	30.0	19.0 - 24.0								10SS16430