

Q-STANDARD



Body: **Steel**
Stem: **Steel**

Countersunk head



Hülse: **Stahl**
Dorn: **Stahl**

Senkkopf



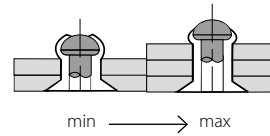
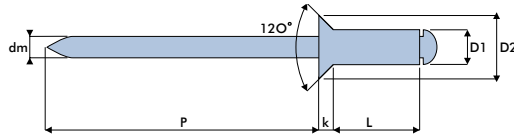

Cuerpo: **Acero**
Vástago: **Acero**

Remache avellanada

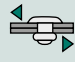

DIN EN ISO 15980

D1	L	 min - max	 mm	D2	k max.	dm ref.	p min.	 [N]	 [N]	code
mm	mm	mm	mm	mm	mm	mm	mm	[N]	[N]	
3.0	6.0	1.5 - 3.0	3.1	6.0	1.0	1.75	26	1100	950	10SS43006
	8.0	3.0 - 5.0								10SS43008
	10.0	5.0 - 6.5								10SS43010
	12.0	6.5 - 8.5								10SS43012
3.2	6.0	1.5 - 3.0	3.3	6.0	1.0	1.92	26	1200	1100	10SS43206
	8.0	3.0 - 5.0								10SS43208
	10.0	5.0 - 6.5								10SS43210
	12.0	6.5 - 8.0								10SS43212
	14.0	8.0 - 11.0								10SS43214
4.0	6.0	1.5 - 3.0	4.1	7.5	1.3	2.35	27	2200	1700	10SS44006
	8.0	3.0 - 5.0								10SS44008
	10.0	5.0 - 6.5								10SS44010
	12.0	6.5 - 8.0								10SS44012
	14.0	7.0 - 10.0								10SS44014
	16.0	8.0 - 12.0								10SS44016
4.8	8.0	2.0 - 4.0	4.9	9.0	1.5	2.90	28	3100	2900	10SS44808
	10.0	4.0 - 6.0								10SS44810
	12.0	6.0 - 8.0								10SS44812
	14.0	7.0 - 9.0								10SS44814
	16.0	8.0 - 11.0								10SS44816
	18.0	9.0 - 13.0								10SS44818
	20.0	11.0 - 15.0								10SS44820
	22.0	13.0 - 17.0								10SS44822