



Body: **Steel**
Stem: **Steel**
Dome head





Hülse: **Stahl**
Dorn: **Stahl**
Flachrundkopf

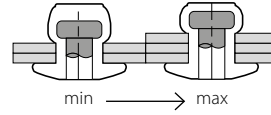
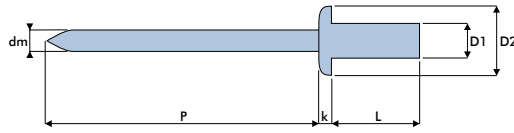

Cuerpo: **Acero**
Vástago: **Acero**
Remache alomada

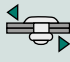

DIN EN ISO 15976

D1	L	 min - max	 mm	D2	k max.	dm ref.	p min.	 [N]	 [N]	code
	mm	mm	mm	mm	mm	mm	mm	[N]	[N]	
3.2	6.0	0.5 - 1.5	3.3	6.1	2.0	1.90	26	2200	1600	20SS13206
	8.0	1.5 - 3.0								20SS13208
	9.5	3.0 - 5.0								20SS13209
	12.0	5.0 - 6.5								20SS13212
4.0	6.0	0.5 - 1.5	4.1	8.0	1.3	2.30	27	2500	2200	20SS14006
	8.0	1.5 - 3.0								20SS14008
	9.5	2.5 - 4.5								20SS14009
	10.0	3.0 - 5.0								20SS14010
	12.0	5.0 - 6.5								20SS14012
4.8	15.0	6.5 - 10.5								20SS14015
	8.0	1.0 - 3.0	4.9	9.5	1.5	2.90	28	3800	2900	20SS14808
	9.5	3.0 - 4.5								20SS14809
	12.0	4.5 - 6.0								20SS14812
	16.0	6.0 - 10.5								20SS14816