

Q-SEALED



Body: **Steel**
Stem: **Steel**
Large head





Hülse: **Stahl**
Dorn: **Stahl**
Großkopf

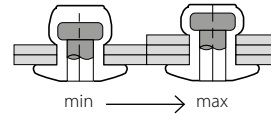
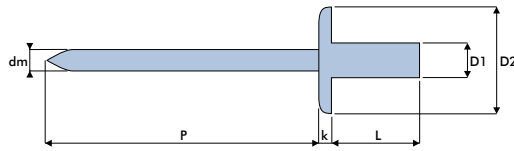

Cuerpo: **Acero**
Vástago: **Acero**
Remache cabeza ancha

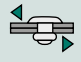

Similar DIN EN ISO 15976

D1	L	 min - max	 mm	D2	k max.	dm ref.	p min.	 [N]	 [N]	code
mm	mm	mm	mm	mm	mm	mm	mm	[N]	[N]	
3.2	6.0	0.5 - 1.5	3.3	9.5	1.7	1.90	26	2200	1600	20SS23206
	8.0	1.5 - 3.0	20SS23208							
	9.5	3.0 - 5.0	20SS23209							
	10.0	3.5 - 5.5	20SS23210							
	12.0	5.0 - 6.5	20SS23212							
4.0	6.0	0.5 - 1.5	4.1	12.0	1.3	2.30	27	2500	2200	20SS24006
	8.0	1.5 - 3.0	20SS24008							
	10.0	3.0 - 5.0	20SS24010							
	12.0	5.0 - 6.5	20SS24012							
	15.0	6.5 - 10.5	20SS24015							
	16.0	7.0 - 11.0	20SS24016							
4.8	8.0	1.0 - 3.0	4.9	14.0	1.7	2.90	28	3800	2900	20SS24808
	9.5	3.0 - 4.5	20SS24809							
	10.0	2.5 - 4.5	20SS24810							
	12.0	4.5 - 6.0	20SS24812							
	16.0	6.0 - 10.5	20SS24816							